



ARAB ALUMINUM CO.

# STANDARD SHAPES



# STANDARD SOLID SECTIONS

A- STD.

قطاعات مصمتة

## ROUND BAR

PROFILE No.	D	WT. kg /m
S -1115	5.5	0.065
S -1101	10	0.212
S -1102	12	0.305
S -1103	15	0.477
S -1112	18	0.687
S -1104	20	0.848
S -1116	22	1.026
S -1105	25	1.325
S -1117	27	1.547
S -1106	30	1.909
S -1118	34	2.452
S -1108	35	2.598
S -1107	40	3.393
S -1109	45	4.292
S -1110	50	5.299
S -1111	60	7.630
S -1113	90	17.177
S -1114	110	25.658

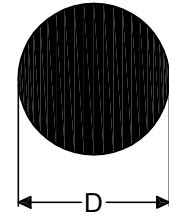

## SQUARE BAR

PROFILE No.	A	WT. kg /m
S -1201	10	0.270
S -1204	10.5	0.298
S -1205	12	0.389
S -1203	25	1.688

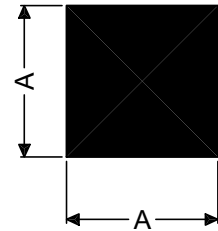

PROFILE No.	A	R	WT. kg /m
S -1202	20	3	1.059

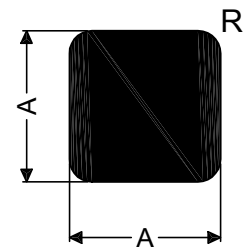

Scale : 1 to 1

Dim. in MM. S.

Approx. weight in kg/m



# STANDARD SOLID SECTIONS

A- STD.

قطاعات مصممة

## RECTANGULAR

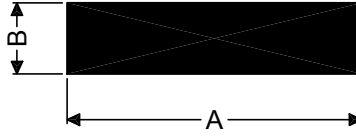

## BAR

PROFILE No.	A	B	WT. kg /m
S-1339	7	4	0.076
S-1338	10	4	0.108
S-1337	10	5	0.135
S-1301	20	3	0.162
S-1317	20	4	0.216
S-1327	20	5	0.270
S-1316	20	6	0.324
S-1320	25	3	0.203
S-1315	25	14	0.945
XAL049	30	1.5	0.122
S-1321	30	10	0.810
S-1302	31	5	0.419
S-1303	40	2	0.216
S-1325	40	3	0.324
S-1323	40	4	0.434
S-1328	40	5	0.540

PROFILE No.	A	B	WT. kg /m
S-1331	40	8	0.864
S-1326	40	10	1.080
S-1313	50	2	0.270
S-1304	50	3	0.405
S-1324	50	5	0.675
S-1312	50	10	1.350
S-1336	52	1.25	0.176
S-1319	54	1.5	0.218
S-1329	60	5	0.810
S-1306	65	4	0.702
S-1307	75	4	0.810
S-1308	85	4	0.918
S-1314	96	2	0.518
S-1333	100	2.2	0.594
S-1330	100	3	0.810
S-1310	135	4	1.458

PROFILE No.	A	B	R	WT. kg /m
S-1305	60	3	3	0.481

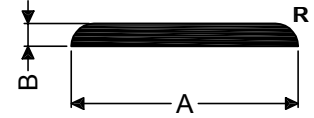

PROFILE No.	A	B	R	WT. kg /m
S-1318	16	5	0.5	0.215
S-1341	52	15	2	2.098
S-1342	77	15	2	3.110
S-1343	90	17	2	4.123
S-1335	100	6	1	1.617
S-1334	120	10	1	3.237

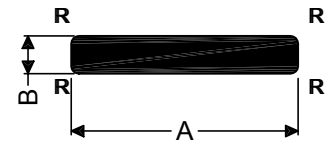

PROFILE No.	A	B	R	WT. kg /m
S-1332	18	4	2	0.186
S-1322	24	7	3.5	0.425
S-1340	28	3	1.5	0.221
S-1309	110	3	1.5	0.891
S-1311	150	12	6	4.776
S-1344	180	12	6	5.748

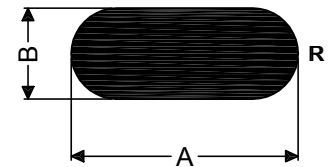

Scale : 1 to 1

Dim. in MM. S.

Approx. weight in kg/m



# STANDARD SOLID SECTIONS

A- STD.

قطاعات مصمتة

**HEXAGONAL**

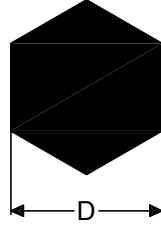

**BAR**

PROFILE No.	D	WT. kg /m
S-1401	16	0.599
S-1402	19	0.845
S-1403	26	1.579

Scale : 1 to 1

Dim. in MM. S.

Approx. weight in kg/m



# STANDARD TUBES

A- STD.

مواسير

## ROUND TUBE

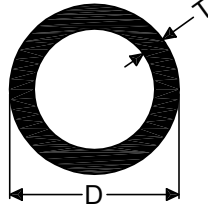

PROFILE No.	D	T	WT. kg /m
H-2182	8	1	0.059
H-2184	8	1.5	0.083
H-2109	10	1.5	0.108
H-2179	10	2	0.135
H-2193	12	1	0.095
H-2149	12	1.5	0.134
H-2142	12	2.6	0.207
H-2420	12	3	0.230
H-2408	14	1.5	0.159
H-2136	14	3	0.280
H-2146	15	1.3	0.151
H-2101	15	1.5	0.172
H-2177	16	1.2	0.150
H-2115	16	2	0.238
H-2137	16	3	0.331
H-2132	16	4	0.407
H-2190	17	2.5	0.308
H-2409	17.8	2.55	0.329
H-2186	18	1.5	0.211
H-2189	18	3.3	0.410
H-2128	18	3.4	0.421
H-2147	18.5	1.2	0.176
H-2413	18.5	3.65	0.459
H-2416	18.5	3.65	0.459
H-2102	19	1	0.153
H-2113	19	1.4	0.209
H-2103	19	2	0.288
H-2191	19	2.5	0.373
H-2123	20	1.5	0.235
H-2401	20	4.4	0.583
H-2117	22	1.3	0.228
H-2160	22	1.5	0.261
H-2197	22	2	0.340
H-2161	22	3	0.483
H-2127	22	3.65	0.568
H-2411	22	4.25	0.640
H-2126	22	4.4	0.657
H-2116	22.5	1.5	0.267
H-2417	23	4.15	0.664
H-2144	24	1.1	0.213

PROFILE No.	D	T	WT. kg /m
H-2122	24	1.3	0.250
H-2406	24.9	1.5	0.297
H-2164	25	1	0.203
H-2112	25	1.5	0.305
H-2104	25	2	0.390
H-2192	25	3	0.559
H-2124	25	4.35	0.762
H-2181	27	1	0.221
H-2130	28	4.75	0.937
H-2418	28.5	5.1	1.013
H-2119	29	2	0.458
H-2105	30	1.4	0.340
H-2167	30	2	0.475
H-2162	30	3	0.686
H-2176	30	5	1.060
H-2402	30	7.65	1.450
H-2403	30	8.75	1.577
H-2151	30.16	4.76	1.026
H-2135	31	3	0.713
H-2125	32	5.5	1.236
H-2428	32	6	1.323
H-2152	33.33	3.17	0.811
H-2120	33.7	3	0.781
H-2140	34	1.2	0.334
H-2148	34	4.75	1.178
H-2165	34	5.35	1.300
H-2415	34	6.1	1.445
H-2174	34.9	2.55	0.700
H-2180	35	1.15	0.330
H-2121	35	7	1.661
H-2424	35	11.25	2.265
GEA-01	35.05	4.45	1.156
H-2405	36	6.25	1.577
H-2404	36	9.75	2.171
H-2114	37	1.6	0.481
H-2195	37.4	1.2	0.367
H-2138	38	6	1.629
H-2429	38	6.5	1.736
H-2187	38	6.75	1.790
H-2414	38	7.5	1.941

Scale : 1 to 1

Dim. in MM. S.

Approx. weight in kg/m





# STANDARD TUBES

A- STD.

علب مربعة

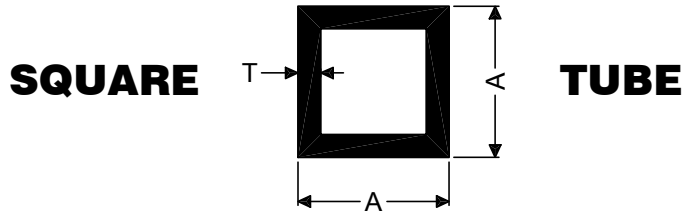

PROFILE No.	A	T	WT. kg /m
H-2233	14	1	0.140
H-2201	16	1.5	0.235
H-2240	20	0.95	0.194
H-2234	20	1.1	0.224
H-2231	20	1.5	0.300
H-2217	20	2	0.389
H-2236	25	1.1	0.284
H-2226	25	1.5	0.381
H-2203	25	2	0.497
H-2212	30	1	0.313
H-2227	30	2	0.605
H-2237	35	1.1	0.402
H-2225	35	1.5	0.543
H-2214/T	40	1.1	0.462
H-2214	40	1.3	0.543
H-2206	40	1.5	0.624
H-2228	40	2	0.821

PROFILE No.	A	T	WT. kg /m
H-2205	40	2.5	1.013
H-2204	40	3	1.199
H-2220	40	4	1.555
H-2239	45	1.2	0.567
H-2210	50	1.5	0.786
Q 2259	50	1.6	0.836
H-2207	50	2	1.036
H-2232	50	3	1.523
H-2219	50	4	1.987
H-2209	60	2	1.253
H-2221	60	4	2.419
H-2208	75	8	5.789
H-2211	80	2	1.685
H-2222	80	4	3.283
H-2213	90	2	1.900
H-2223	100	4	4.147
H-2216	101.6	2	2.159

PROFILE No.	A	T	R	WT. kg /m
H-2238	15	1.5	1.2	0.216
H-2224	19	1	0.5	0.194
H-2202	19	1.25	1	0.238

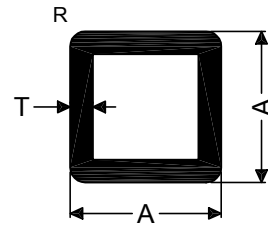

PROFILE No.	A	T	R	r	WT. kg /m
H-2235	25	1.7	2	0.3	0.419
H-2229	25	2	1.8	1.8	0.486
SB-1	50.8	1.83	6.3	4.47	0.923
H-2230	50.8	2.03	6.35	4.32	1.019

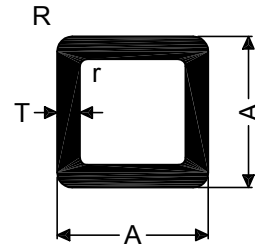

Scale : 1 to 1

Dim. in MM. S.

Approx. weight in kg/m



# STANDARD TUBES

A- STD.

علب مستطيلة

## RECTANGULAR

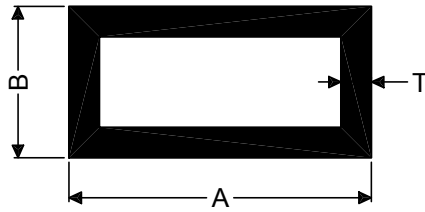

## TUBE

PROFILE No.	A	B	T	WT. kg /m
H-2317	20	10	1.5	0.219
H-2301	20	10	2	0.281
H-2302	25	12.5	1.5	0.280
H-2349	25	15	1.25	0.254
H-2350	40	15	1.3	0.367
H-2366	40	20	0.95	0.297
H-2346	40	20	1.1	0.343
H-2329	40	20	1.3	0.403
H-2305	40	20	1.5	0.462
H-2328	40	20	3	0.875
H-2348	50	20	1.2	0.437
H-2339	50	20	2	0.713
H-2325	50	25	1.7	0.657
H-2340	50	25	2	0.767
H-2338	50	30	3	1.199
H-2358	60	40	1.2	0.632
H-2341	60	40	2	1.037
H-2347	75	25	1.1	0.581
H-2323	75	25	2	1.037
H-2307	75	40	2	1.199
H-2306	75	40	4	2.311
H-2360	80	15	1.1	0.551
H-2344	80	20	1.1	0.580
H-2324	80	20	1.5	0.788
H-2311	80	20	2	1.037
H-2333	80	40	1.1	0.700

PROFILE No.	A	B	T	WT. kg /m
H-2330	80	40	1.3	0.824
H-2310	80	40	1.5	0.948
H-2309	80	40	1.7	1.070
H-2308	80	40	2	1.253
H-2334	80	40	4	2.419
H-2363	80	45	1.3	0.859
H-2327	80	60	2	1.468
H-2359	90	50	4	2.851
H-2345	100	20	1.1	0.699
H-2321	100	20	1.7	1.071
H-2318	100	25	1.6	1.053
H-2367	100	40	1	0.745
H-2342	100	40	1.3	0.965
H-2319	100	40	1.7	1.254
H-2314	100	40	2	1.469
H-2313	100	40	2.5	1.823
H-2312	100	40	3	2.171
H-2361	100	45	1.2	0.923
H-2315	100	45	2	1.523
H-2316	100	45	3	2.252
H-2343	100	50	1.3	1.035
RB -1	100	50	1.6	1.268
H-2320	100	50	2	1.577
H-2335	100	50	4	3.067
H-2331	120	30	1.8	1.423
H-2364	140	43	2	1.933
H-2362	150	50	3	3.143

PROFILE No.	A	B	T	R	WT. kg /m
H-2353	25	15	1.3	1.2	0.259
H-2336	25	15	1.3	1.5	0.258
H-2354	30	18	1.2	1.2	0.292
H-2304	40	20	2	3	0.584

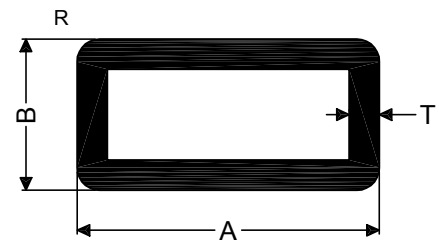

Scale : 1 to 1

Dim. in MM. S.

Approx. weight in kg/m





# STANDARD TUBES

A- STD.

علب مستطيلة

**RECTANGULAR**

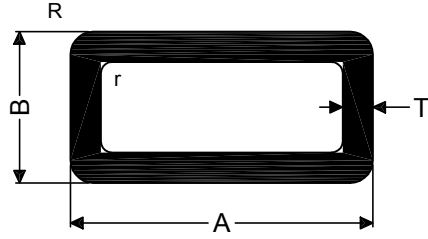

**TUBE**

PROFILE No.	A	B	T	R	r	WT. kg /m
H-2326	22	10	1.5	2.5	1	0.223
H-2356	33	20	1.25	3	1.75	0.327
H-2322	33	22	1.5	4.5	3	0.398
H-2303	33.5	18.5	1.5	2	0.5	0.397
H-2357	35	20	1.1	2.5	1.4	0.302
H-2337	38.1	25.4	1.5	3	1.4	0.490
H-2355	40	20	1.25	3	1.75	0.375
H-2365	50	16	1.5	2	0.5	0.502
H-2332	78	24.5	1.5	5	3.5	0.776
H-2352	84	25	1.4	2.5	1.1	0.791
H-2351	97	25	1.5	3.5	2	0.945

Scale : 1 to 1

Dim. in MM. S.

Approx. weight in kg/m



# STANDARD EQUAL ANGLES

A- STD.

زوايا متساوية الابعاد

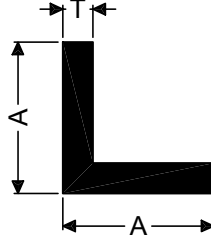

PROFILE No.	A	T	WT. kg/m
F-3215	10	1.5	0.075
F-3220	12	2	0.119
F-3241	15	1.1	0.086
F-3214	15	1.4	0.108
F-3201	15	2	0.151
F-3223	18	1.4	0.131
F-3234	20	1	0.105
F-3203	20	1.3	0.135
F-3229	20	1.4	0.145
F-3202	20	2	0.205
F-3222	23	1.4	0.169
F-3238	25	1.1	0.146
F-3228	25	1.4	0.184
F-3205	25	1.3	0.170
F-3204	25	2	0.259
F-3230	25	3	0.381
F-3226	28	1.4	0.206
F-3237	30	1.1	0.176
F-3221	30	1.5	0.237
F-3216	30	2	0.313
F-3242	30	2.7	0.419
F-3206	30	3	0.462
F-3240	35	1.1	0.205
F-3207	35	1.5	0.277
F-3244	35	3	0.543
F-3245	35	4	0.713
F-3219	38	3.2	0.629

PROFILE No.	A	T	WT. kg/m
F-3239	40	1.1	0.235
F-3224	40	1.5	0.318
F-3227	40	1.8	0.380
F-3208	40	2	0.421
F-3231	40	2.9	0.604
F-3218	40	3	0.624
F-3209	40	4	0.821
F-3210	45	3.5	0.860
F-3232	50	1.4	0.373
F-3225	50	1.5	0.400
F-3211	50	2	0.529
F-3233	50	3	0.786
F-3212	50	5	1.296
F-3243	60	1.4	0.448
F-3217	60	5	1.553
F-3213	65	2	0.691
F-3236	70	8	2.851
F-3235	100	8	4.147

Scale : 1 to 1

Dim. in MM. S.

Approx. weight in kg/m



# STANDARD NONEQUAL ANGLES

A- STD.

زوايا مختلفة الابعاد

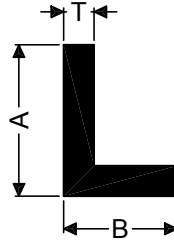

PROFILE No.	A	B	T	WT. kg /m
F-3325	20	10	1.5	0.116
F-3312	20	12	1.4	0.116
F-3301	20	15	2	0.178
F-3319	25	12	1.4	0.135
F-3310	25	20	1.4	0.165
F-3322	25	20	2.5	0.287
F-3303	30	15	2	0.232
F-3326	30	15	3	0.340
F-3313	32	20	1.4	0.192
F-3320	40	12	1.4	0.191
F-3304	40	15	1.5	0.216
F-3323	40	20	1.1	0.176
F-3315	40	20	1.4	0.221
F-3316	40	20	2	0.313
F-3321	40	25	1.4	0.240
F-3324	45	13	1.5	0.230
F-3305	45	25	4	0.713
F-3317	50	20	2	0.367
F-3311	50	25	1.4	0.278
F-3306	50	30	3	0.624
F-3314	70	25	1.4	0.354
F-3309	70	40	1.8	0.526
F-3318	80	40	4	1.253
F-3307	80	75	6	2.414
F-3308	115	35	3	1.191

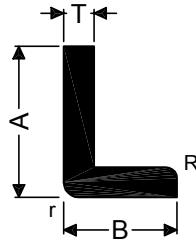

PROFILE No.	A	B	T	R	r	WT. kg /m
F-3302	20	13	3	1	1.5	0.241

Scale : 1 to 1

Dim. in MM. S.

Approx. weight in kg/m



## -U- SECTION

قطاعات نمطية

A- STD.

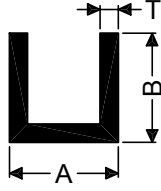

PROFILE No.	A	B	T	WT. kg /m
F-3415	10	8	1.6	0.098
F-3413	10.6	10	1.3	0.097
F-3414	11.5	10.5	1.6	0.127
F-3401	15	10	1.5	0.130
F-3447	15	22	1.5	0.227
F-3422	16	20	2	0.281
F-3446	17	12	1.5	0.154
F-3405	18.6	20	1.3	0.197
F-3404	19	25	1	0.181
F-3444	20	20	1.2	0.186
F-3423	20	20	1.5	0.231
F-3406	21.5	21.5	1.5	0.249
F-3448	22	22.5	2.5	0.419
F-3407	23	21.5	1.5	0.260
F-3424	24.8	15	1.4	0.197
HD-6	25	25	1.6	0.310
F-3436	25	25	2	0.383
F-3440	30	30	4	0.886
F-3416	33	10	1.5	0.203
F-3408	35	20	2	0.383
F-3451	36	24	3	0.632
F-3431	38.6	25	1.4	0.311
F-3409	40	20	1.5	0.312
F-3410	40	20	2	0.411
F-3450	43	27	3	0.737
F-3417	44	20	2	0.432
F-3445	45	38	3.8	1.164
F-3443	47	40	4	1.285
F-3437	50	25	2.5	0.641
F-3441	50	30	3	0.842
F-3411	50	40	3	1.005
F-3425	53.6	40	1.8	0.632
F-3421	54	20	3	0.712
F-3412	60	25	2	0.572
F-3438	60	40	4	1.426
F-3426	78.6	40	1.8	0.753
F-3419	80	25	2	0.680
F-3429	100	50	5	2.565
F-3442	100	50	6	3.046
F-3427	103.6	40	1.8	0.875

PROFILE No.	A	B	T	WT. kg /m
F-3430	123.6	40	1.8	0.972
F-3428	153.6	40	1.8	1.118

Scale : 1 to 1

Dim. in MM. S.

Approx. weight in kg/m



# -U- SECTION

A- STD.

## قطاعات نمطية

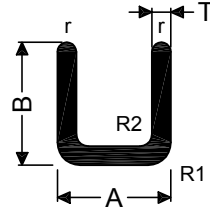

PROFILE No.	A	B	T	R1	R2	r	WT. kg /m
F-3435	28.9	45	1.4	5	3.6	0.7	0.425
F-3434	28.9	38	1.4	5	3.6	0.7	0.375
F-3433	38.9	38	1.4	5	3.6	0.7	0.413
F-3432	38.9	45	1.4	5	3.6	0.7	0.463

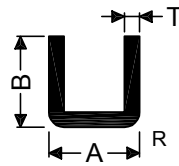

PROFILE No.	A	B	T	R	WT. kg /m
F-3403	16	14	2	2.5	0.210

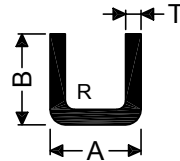

PROFILE No.	A	B	T	R	WT. kg /m
F-3402	15	28	2	0.5	0.370

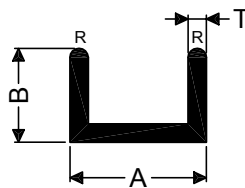

PROFILE No.	A	B	T	R	WT. kg /m
CH-4	41.91	25.4	1.57	0.785	0.380
F-3439	50	15.5	1.2	0.6	0.254

Scale : 1 to 1

Dim. in MM. S.

Approx. weight in kg/m



# -U- SECTION

A- STD.

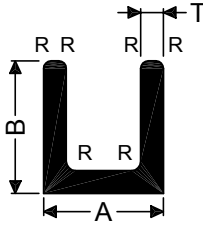

PROFILE No.	A	B	T	R	WT. kg /m
GH01	25	35	2	0.5	0.491

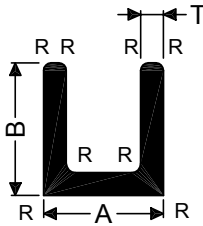

PROFILE No.	A	B	T	R	WT. kg /m
9158	25	25	3	0.38	0.558

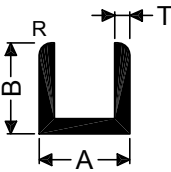

PROFILE No.	A	B	T	R	WT. kg /m
F-3418	67	40	2	2	0.855

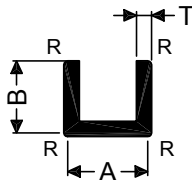

PROFILE No.	A	B	T	R	WT. kg /m
F-3420	14	10	2	0.5	0.162

Scale : 1 to 1

Dim. in MM. S.

Approx. weight in kg/m



# DOUBLE -U- SECTION

A- STD.

قطاعات نمطية

PROFILE No.	A	B	T	WT. kg /m
F-3501	12	8	1.2	0.104
F-3505	16.5	15	1.5	0.232
F-3502	18	8	2	0.194
F-3506	20.2	9.5	1.4	0.168
F-3504	20.5	15	1.5	0.247

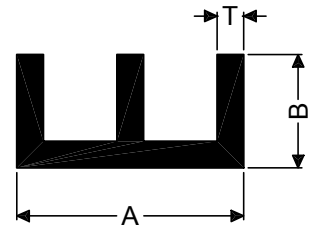

PROFILE No.	A	B	T	R	WT. kg /m
F-3503	19.3	11	1.1	0.55	0.146
F-3507	20	15	1.5	0.75	0.243

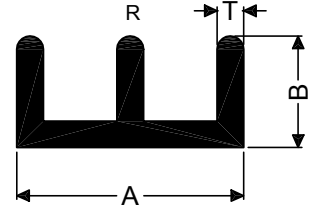

Scale : 1 to 1

Dim. in MM. S.

Approx. weight in kg/m



# -T- SECTION

A- STD.

## قطاعات نمطية

PROFILE No.	A	B	T	WT. kg /m
F-3601	15	15	2	0.151
F-3610	20	20	2	0.205
F-3603	25	20	1.5	0.176
F-3602	25	25	2	0.259
F-3609	30	15	1.4	0.170
F-3604	30	30	2	0.313
F-3605	25	45	4	0.713
F-3611	40	40	4	0.821
F-3612	40	40	5	1.013
F-3606	50	50	4	1.037
F-3613	70	40	2.5	0.726
F-3608	70	70	3	1.110
F-3614	120	45	3.5	1.526

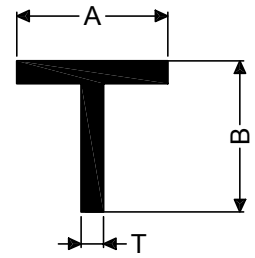

PROFILE No.	A	B	T	R	WT. kg /m
F-3607	75	88	13	2	5.260

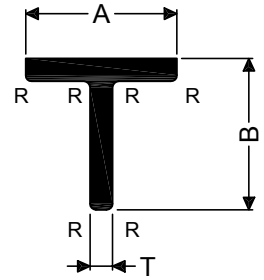

Scale : 1 to 1

Dim. in MM. S.

Approx. weight in kg/m





# -H- SECTION

A- STD.

قطاعات نمطية

PROFILE No.	A	B	T	WT. kg /m
F-3702	34.6	60	1.8	0.734
F-3705	43.4	43.4	1.2	0.413
F-3706	47	47	3	1.094
F-3704	50	50	2	0.788

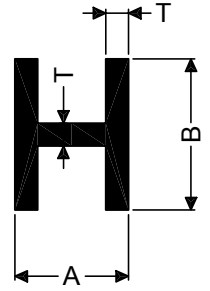

PROFILE No.	A	B	C	T	R	WT. kg /m
F-3701	40	18	3	2	0.5	0.476

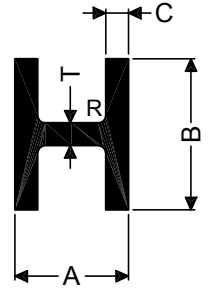

PROFILE No.	A	B	T	R	WT. kg /m
F-3703	8.8	21	1.3	0.65	0.167

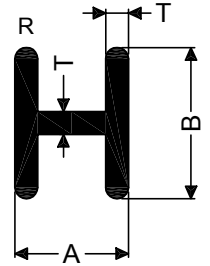

Scale : 1 to 1

Dim. in MM. S.

Approx. weight in kg/m



# STANDARD SECTION

A- STD.

قطاعات نمطية

PROFILE No.	A	B	C	T	WT. kg /m
F-3801	23.5	11.6	2	3.5	0.186
F-3802	28.5	11.6	2	3.5	0.213

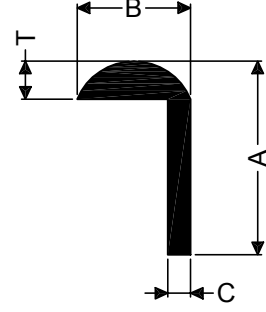

PROFILE No.	A	B	WT. kg /m
F-3902	16	4	0.099
F-3901	25.5	4.2	0.197
F-3903	30	3.5	0.191

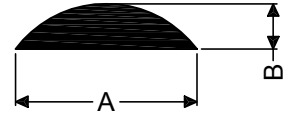

Scale : 1 to 1

Dim. in MM. S.

Approx. weight in kg/m